

GENERAL

ZDRV electronic V-type ball control valve is a rotary type control valve which is the administer cell in the electric combination and can make percentage control. It has several characteristics ,such as small flow resistance, easy flow way, big flow coefficient, proximate equal percentage offered by 1/4 sphere V-type gap core and through shearing function to control viscous medium with fiber and small granule. The ball valve matched actuator can receive signal of ON-OFF or 4-20mA or 1~5VDC, which is mini type, solidity and high precision. It has adopted angle direct indication and feedback. The product is widely applied in petrol, chemical industry, papermaking, metallurgy, sewage treatment, which assure the manufactured processing according to the specification.

SPECIFICATIONS AND TECHNICAL DATA

BODY

Body style: Straight foundry ball valve

DN: 25~300mm

PN: PN16, 40, 63,100 MPa

Joint style: Clamp (DN25~50) Flange (DN25~50)

Flange standard: Steel flange as per ANSI B16.5,DIN,GB9113-2000, JB/T-94

Format of sealing surface: Convex face for PN16MPa, Convex &concave for PN 40, 63,100MPa

Face to Face Dimension: as per ANSI B16.10,DIN

Material: Body, inner components matched material and work temperature range refer to the table 1 in the ZSHV

Structural style: As per the core eccentricity or not (chart 1)

As per the material of ball seat

* soft seal (-20℃ ~ +180℃)

*metal hard seal

As per valve structure

*jacket type

Press-cap: Press-plate format

Packing: V-pattern PTFE, soft graphite

Gasket: Pattern.....tooth-shape and flat

Material.....F4/reinforced F4, stainless steel and graphite

ZDRV Structure

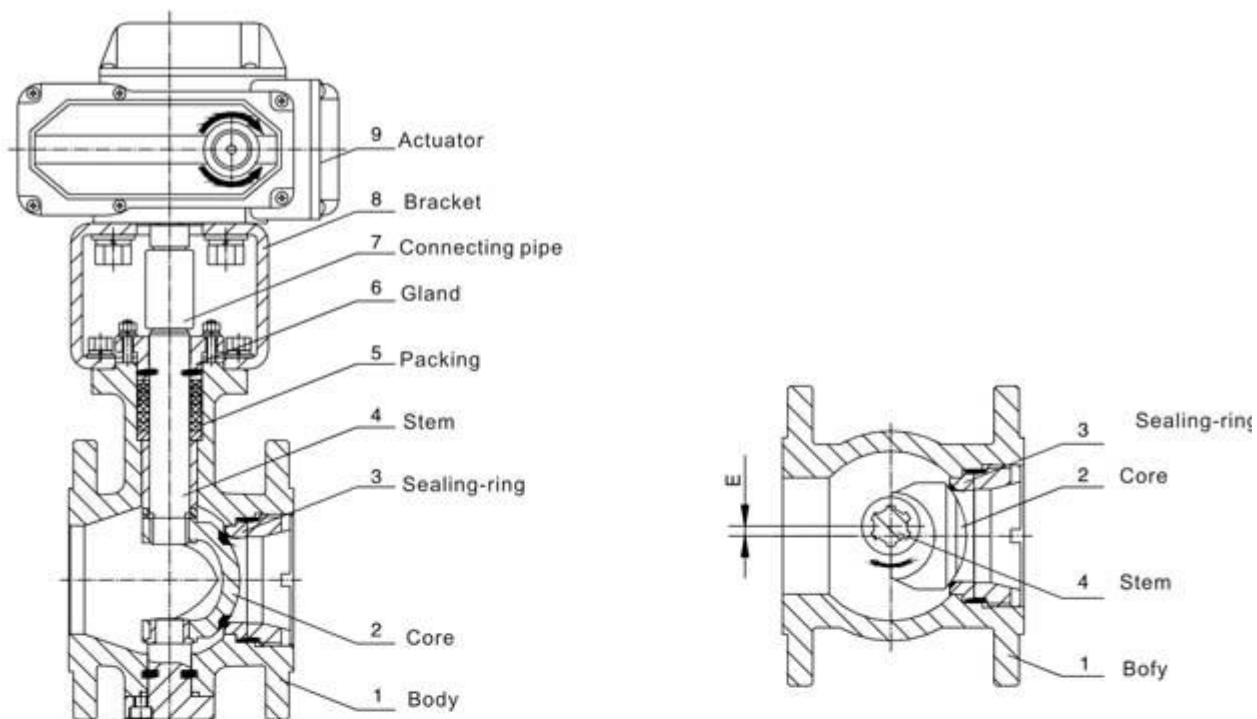

Chart 1 ZDRVE Eccentricity V-type ball valve

Eccentricity sketch map

Table 2 Permitted DIF PRE

Unit:MPa

Nominal boreDN(mm) 25 32 40 50 65 80 100 125 150 200 250 300

Actuator

		25	32	40	50	65	80	100	125	150	200	250	300
Nucom-10NS	Soft seal	10.0	7.50										
	Metal seal	3.27	2.00										
	Soft seal	10.0	10.0	8.57	5.00								
	Metal seal	6.56	4.00	2.67	1.60								
Nucom-10NM	Soft seal			10.0	10.0	6.00							
	Metal seal			5.33	3.20	2.13							
	Soft seal					10.0	6.67	3.75					
	Metal seal					4.26	2.56	1.60					
	Soft seal						8.33	4.69	2.31				
	Metal seal						3.20	2.00	1.25				
Nucom-10NL	Soft seal							9.38	4.62	2.73			
	Metal seal							4.00	2.50	1.60			
	Soft seal								6.92	4.09	3.00	1.80	
	Metal seal								3.75	2.40	1.33	0.80	
	Soft seal									5.45	4.00	2.40	1.78
	Metal seal									3.20	1.78	1.07	0.67

ZAJO Structure

Exterior dimension and weight

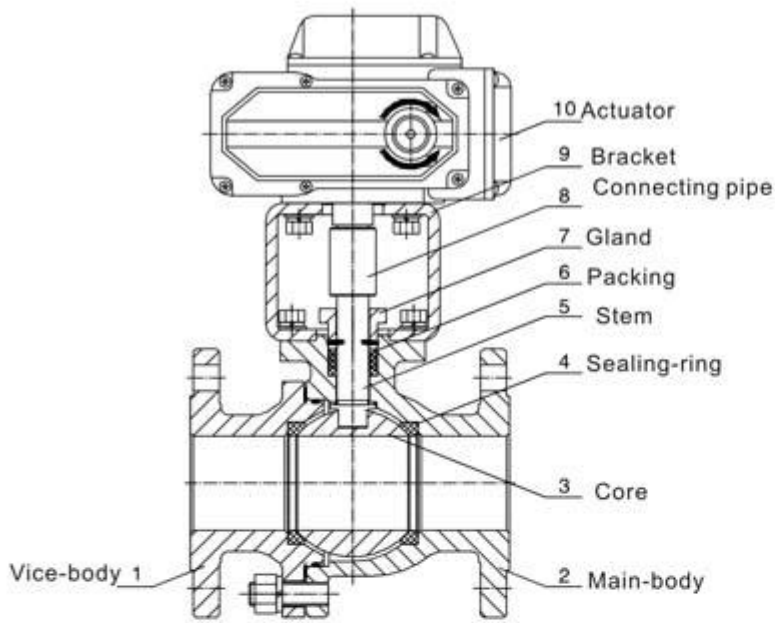

Chart 1 ZAJO Soft seal

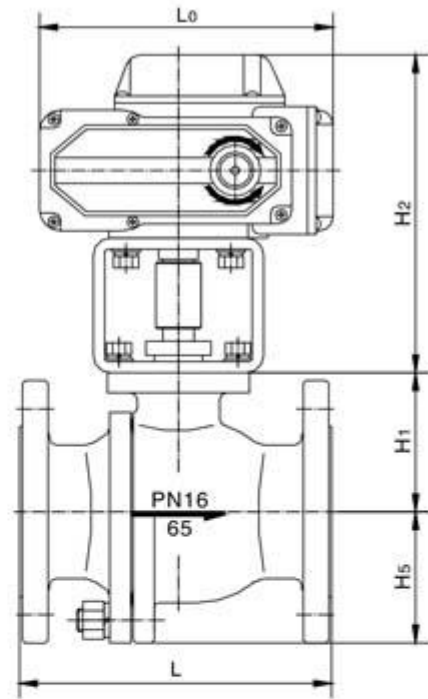

Table 3

Unit:mm

Nominal bore DN	15	20	25	32	40	50	65	80	100	125	150	200	250	300	
L ₀	157.5	157.5	157.5	207	207	207	256	256	256	380	380	380	380	380	
L	PN16/40	130	130	140	165	165	203	222	241	305	356	394	457	533	610
	PN63	165	190	216	229	241	292	330	356	406	455	495	597	673	762
H ₁	54	54	60	67	78	88	98	121	144	148	176	226	281	320	
H ₂	152	152	152	187	187	204	235	235	245	315	315	352	352	363	
H ₅	47	47	52	59	66	78	91	106	130	150	172	215	270	330	
Weight (kg)	PN16/40	6.5	7	9	13.5	18	26	33	48	88	115	200	245	340	456
	PN63	7.5	8.5	11	16	21.5	32	41	58	106	138	240	294	408	548

Note: 1. The data is comply with PN16 data.

2. Both H₁ and H₅ of jacket valve should increase 15%.

3. Valve body flange and the distance between flange and flange surface as per specified standard offered by customer. For example: ANSI, JIS, DIN standard.